

LOC		DIST		REVISIONS			
AD	25	REV	DATE	BY	CHK	APPV	
J1		REVISED PER ECO-08-002028	23JAN08	DH		AS	

- 1 HOUSING MATERIAL: THERMOPLASTIC.
- 2 CONTACT MATERIAL: COPPER ALLOY.
- 3 CONTACT FINISH: .000050-.000100 NICKEL UNDERPLATE ALL OVER WITH .000030 GOLD IN CONTACT AREA AND .000100-.000200 TIN-LEAD PLATED POSTS.

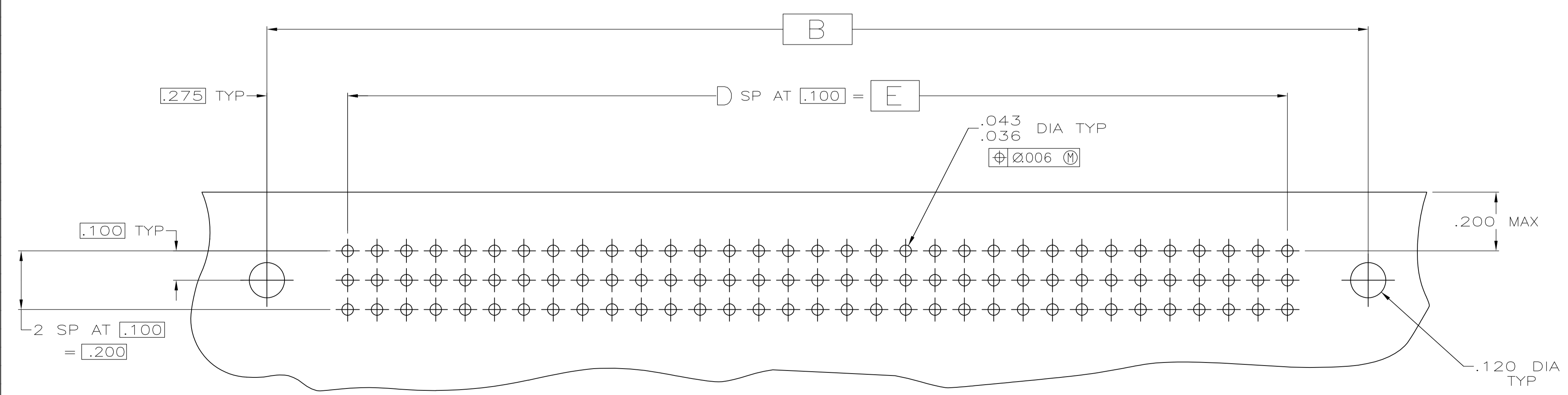
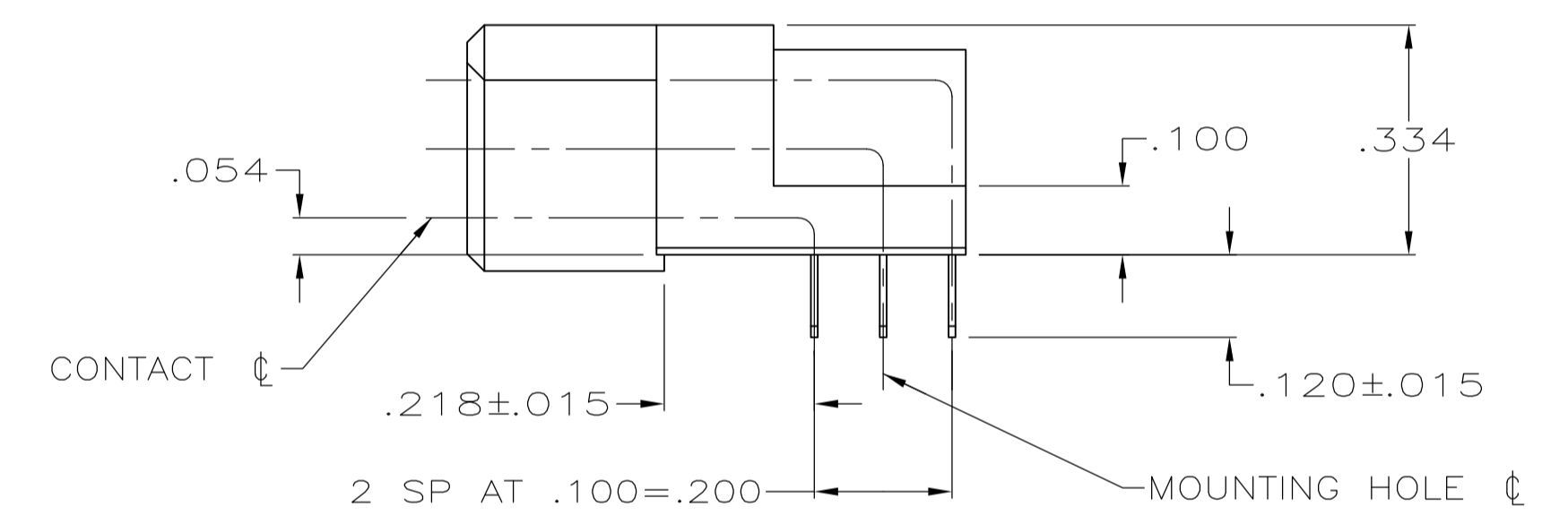
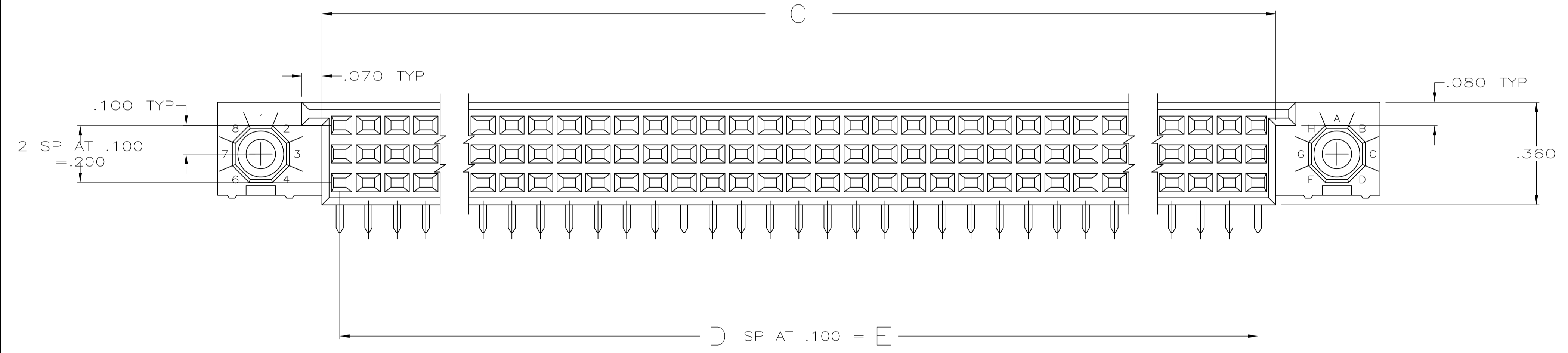
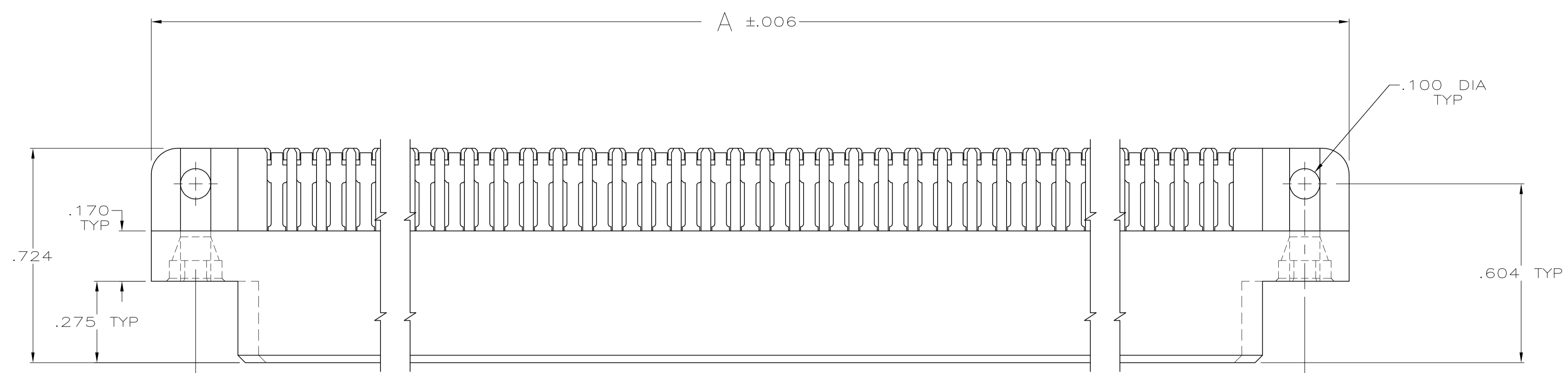

RECOMMENDED P.C. BOARD LAYOUT

	5.900	59	6.024	6.450	6.750	180	534026-9
	5.400	54	5.524	5.950	6.250	165	534026-8
OBSOLETE	7.900	79	8.024	8.450	8.750	240	534026-7
OBSOLETE	7.400	74	7.524	7.950	8.250	225	534026-6
OBSOLETE	6.900	69	7.024	7.450	7.750	210	534026-5
OBSOLETE	4.900	49	5.024	5.450	5.750	150	534026-4
	3.900	39	4.024	4.450	4.750	120	534026-3
	3.100	31	3.224	3.650	3.950	96	534026-2
OBSOLETE	2.900	29	3.024	3.450	3.750	90	534026-1
	E	D	C	B	A	NO OF POSN	PART NUMBER

THIS DRAWING IS A CONTROLLED DOCUMENT.

DIN: J. GALLUCCI BG 6-13-91
 CHK: DAVID HOFFMAN 12/10/91
 APPV: -

Product Name: ASSEMBLY, RECEPTACLE, TWIN BEAM CONNECTOR, .120 POST LENGTH, 3 ROW, 2 MOUNTING HOLES.
 Product Spec: 108-1098
 Application Spec: 114-9008

Material: 1 2 3
 Finish: 3

Weight: -
 Scale: 4:1
 Sheet: 1 of 1
 Rev: J1

Customer Drawing: A100779C=534026